

SECTIUNE LONGITUDINALA PRIN AXUL PODULUI

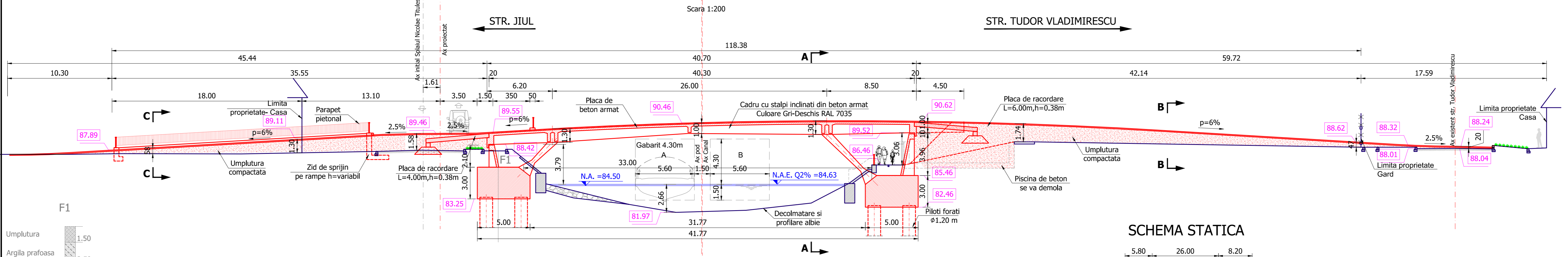

SECTIUNE LONGITUDINALA PRIN AXUL str. SPLAIUL NICOLAE TITULESCU

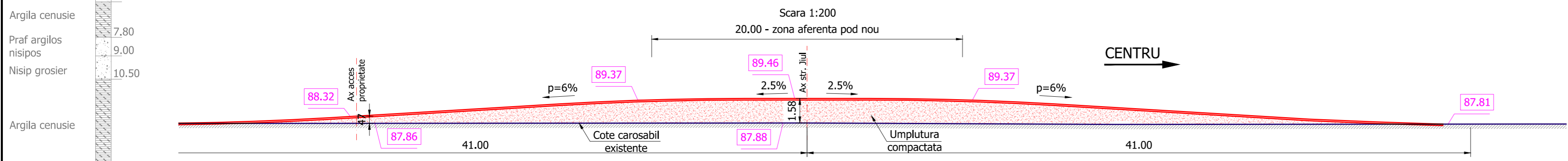

SCHEMA STATICA

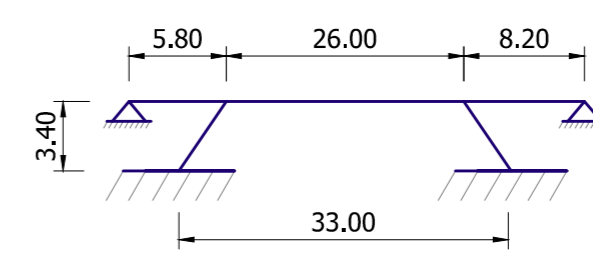

Convoi de calcul: conform SR EN 1991-2:2004.
 Acceleratia terenului pentru proiectare: $a_g=0.20g$
 Perioada de colt a spectrului de raspuns: $T_c=0.7s$
 Exigenta de calitate: A4, B2, D2

- LEGENDA:**
- Suprafata existenta
 - ▨ Beton existent
 - ▨ Lucrari proiectate
 - Lucrari proiectate
 - ▨ Cladiri existente

SECTIUNE TRANSVERSALA A - A

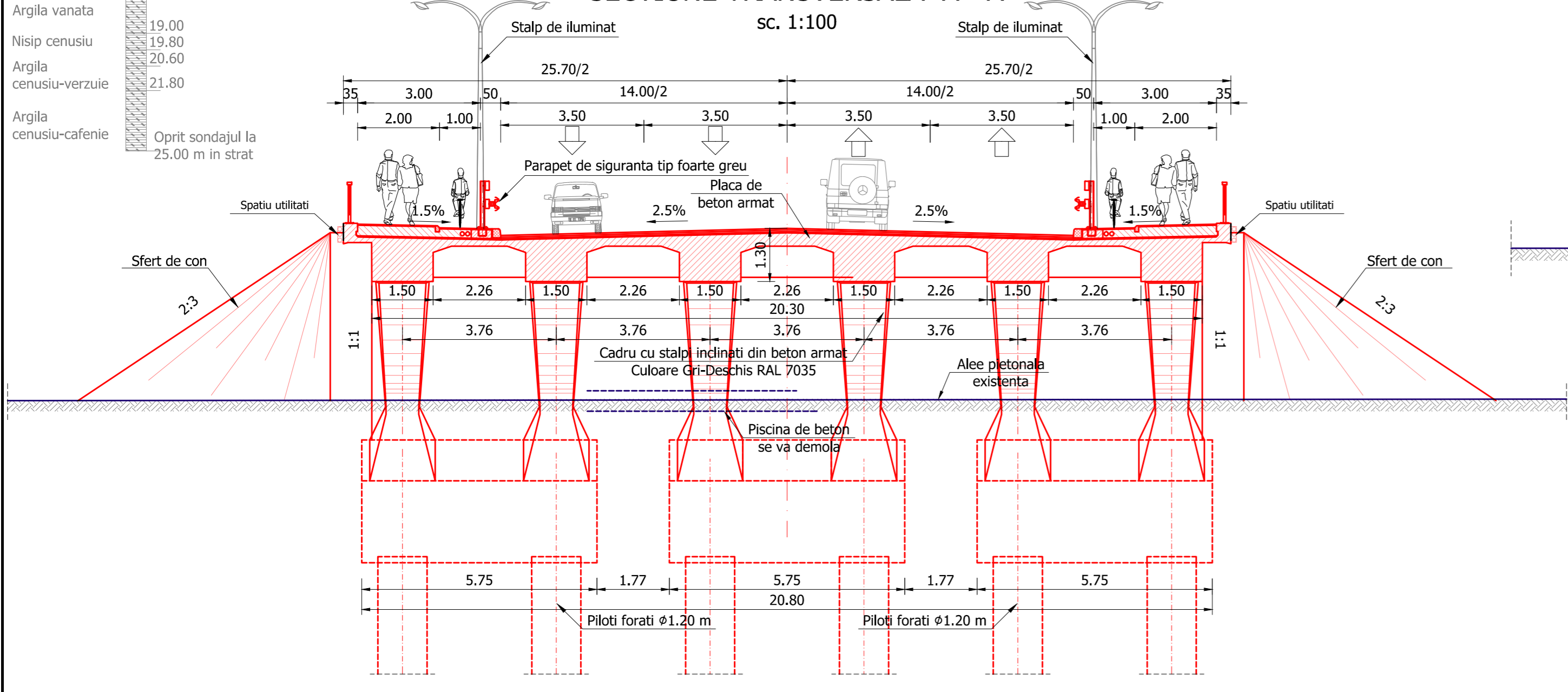

SECTIUNE TRANSVERSALA B - B

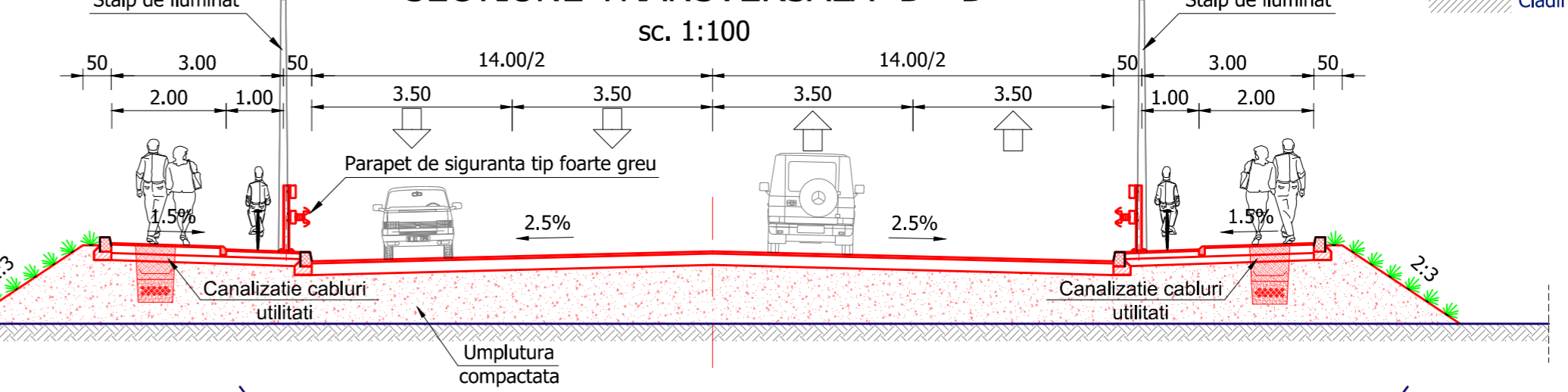

SECTIUNE TRANSVERSALA C - C

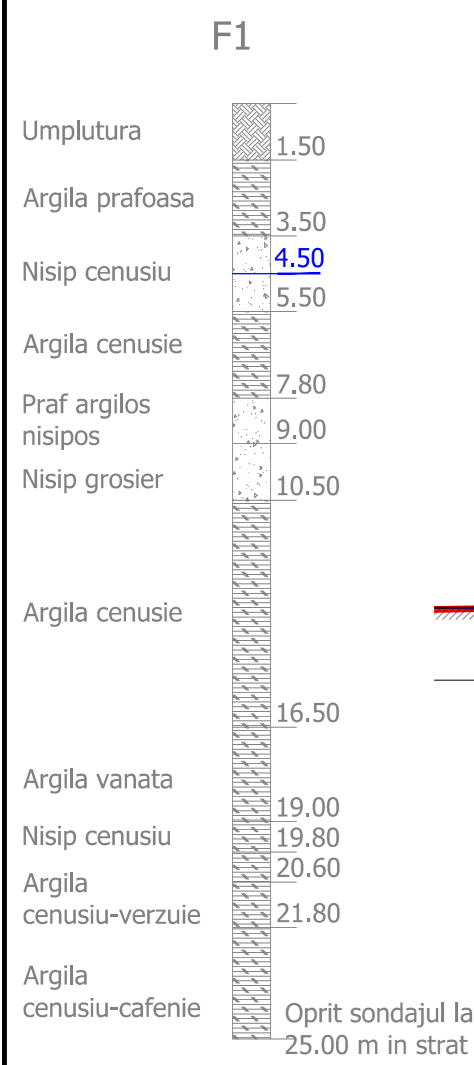
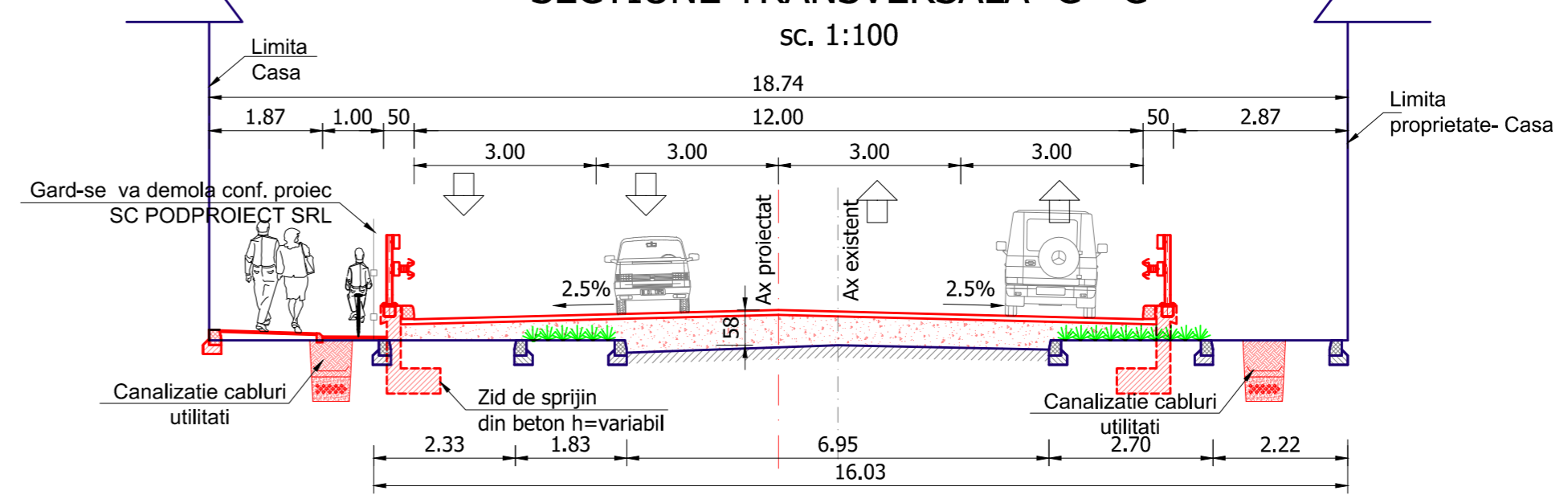

| Revizua | Descriere | Data |
|---|-----------------------|--------------------|
| Verificator proiect/Expert tehnic | | |
| Verificator proiect/Expert tehnic | | |
| Verificator proiect/Expert tehnic | Nume si prenumele | Semnatura |
| VCE Vienna Consulting Engineers S.R.L. EUROBRIDGE S.R.L. | | |
| Municipii Timisoara | | |
| Servicii de proiectare Construire Pod peste Bega - strada Jiul | | |
| Contract | 227/15.07.2015 | |
| Numar Proiect | 15-2708 | S.F. |
| STUDIU DE FEZABILITATE DISPOZITIE GENERALA SOLUTIA 2. PARTEA I | | |
| PROIECTAT | Ing. Razvan CODREANU | |
| DESEINAT | Ing. Razvan CODREANU | |
| VERIFICAT | Ing. Catalin GRUIANU | |
| APROBAT | Ing. Dipl. Marcus STU | |
| Data | Decembrie 2016 | Scara 1:100; 1:200 |
| Numar Plan: TM-PJ-SF-P07-DG, rev.2 | | |